

EXCESS 11



XCS
Excess







THE WORLD HAS CHANGED, AND SO HAS SAILING.

The **Beneteau family shipyard**, founded in 1884 in Saint-Gilles-Croix-de-Vie in **Vendée** (France), has evolved with the times over decades.

For over 140 years, the men and women of the Beneteau Group have developed a passion for products, a sense of innovation and a constant commitment to customers and the environment.

The **Excess** brand was created 4 years ago to offer those who seek the comfort of a **catamaran** and combined with **sensations of sailing**.





SEEK SENSATIONS

At Excess, **breaking new ground** isn't revolutionary. It's simply what we do. Unique cruising catamarans with a **dynamic design and our disruptive attitude** set us apart.

This is how we offer **the thrill of sailing without sacrificing comfort**. Thereby, we are your gateway for exciting activities on, in, and around the sea.

Created for sailors looking for their next adventure.







Excess 11



The Excess 11 is a lively sailing catamaran which does not sacrifice the comfort and volume attributes needed for enjoyable cruising.



NAVAL ARCHITECT
VPLP design

This is the synthesis of the Excess spirit: a beautiful, simple, comfortable boat, with a generous sail plan!



INTERIOR DESIGNER
Nauta Design

Available in 3 and 4 cabins versions.

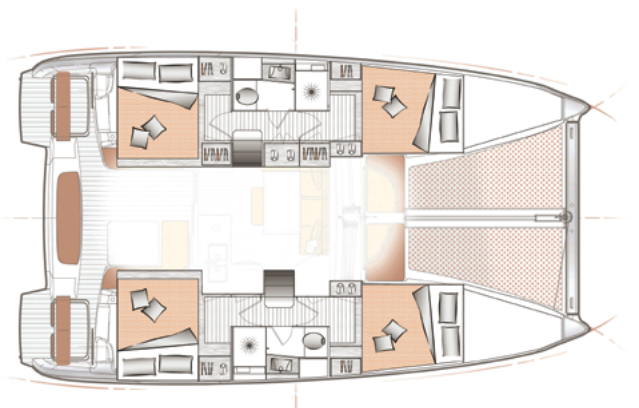
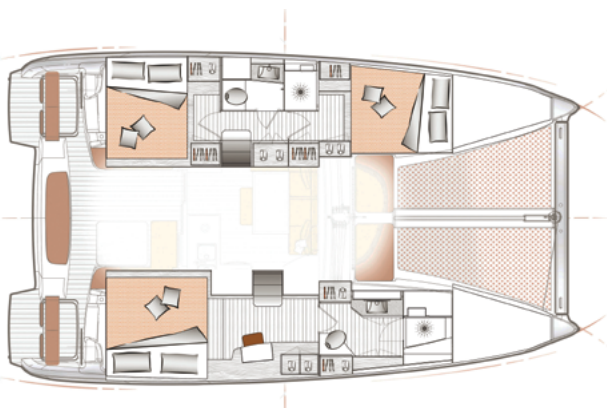



Overall Length	11,42 m / 37'6"
Hull Length	11,33 m / 37'2"
Beam	6,59 m / 21'7"
Mast clearance (std/pulse)	17.27 m 56'7" / 18.26 m 59'1"
Draft	1,15 m / 3'9"
Light displacement	9 T / 19,845 lbs
EC certification	A : 8 - B : 12 - C : 16 - D : 20



Square top mainsail	55 m² / 592 sq.ft
Overlapping genoa	32.5 m² / 349.8 sq.ft
Code 0 (option)	54 m² / 581 sq.ft
Upwind sail area	90 m² / 968.8 sq.ft

PULSE LINE

The choice for bold sailors
Seeking sensations

Upwind sail area **95.5 m² / 1028 sq.ft**



2 x 200 L
2 x 53 US gal



2x29 HP



300 L + 300 L (opt)
79 US gal + 79 US gal (opt)



2 x 80 L
2 x 21 US gal



6 to 12

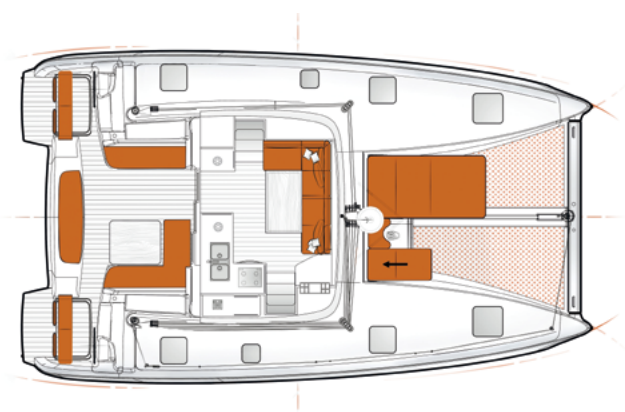
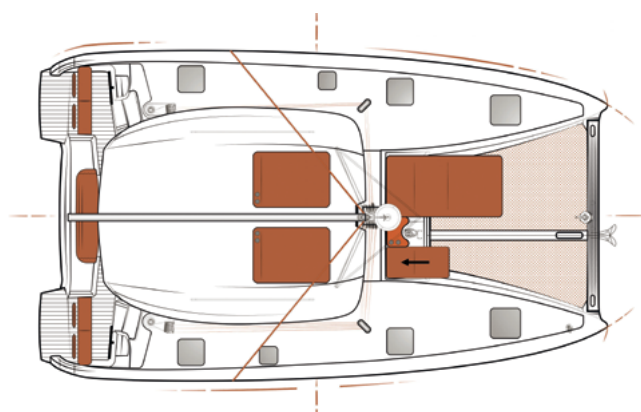





Excess 11





Excess 11





OUR DISTRIBUTION NETWORK

The Excess distribution network covers the entire world, partnering with selected individuals that are dedicated to excellence and customer satisfaction. Our Excess distributors, located in all key destinations, are there to help you discover our catamarans and accompany you on your adventure at sea.



Find your
local Excess
Expert !





MEET THE TRIBE

We are young at heart: we enjoy taking new ideas on board or even pioneer new concepts in sailing. And we don't want to do this alone! Excess is a community of Owners, Dealers, Partners, enthusiasts, experts and all together we are the Excess tribe.

We collaborate, we exchange, we share, we question each other, we don't have all the answers but we build together the catamaran world that we dream of.

Welcome to the Excess tribe !



EXCESS CAMPUS



«The **Excess Campus**»
is an unmissable
event for all **sailing**
enthusiasts.



These **exclusive training** seminar
allow us to share our knowledge
and experience with our clients and
professionals of the nautical industry,
and to connect with the members of
the Excess tribe, who have a common
passion for the sea.





JOIN THE EXCESS LAB

The Excess Lab gives you the opportunity to join our Design Team, to interact with our specialists and naval architects. You will discover the features we are currently working-on and will be invited to join in the decision making process when selecting the options we will feature on our next Excess catamarans.

The Excess Lab also allows you to post your suggestions and to share the topics you would like our Team to investigate or develop.

"We are convinced that connecting you, sailors, with our professional team will be an enriching experience for all. It will bring us a lot, no doubt. We certainly hope that you will love and appreciate this sharing of ideas as well!"

Thibaut de Montvalon, Excess Director



DESIGN THE CATAMARANS OF TOMORROW

Share your ideas.

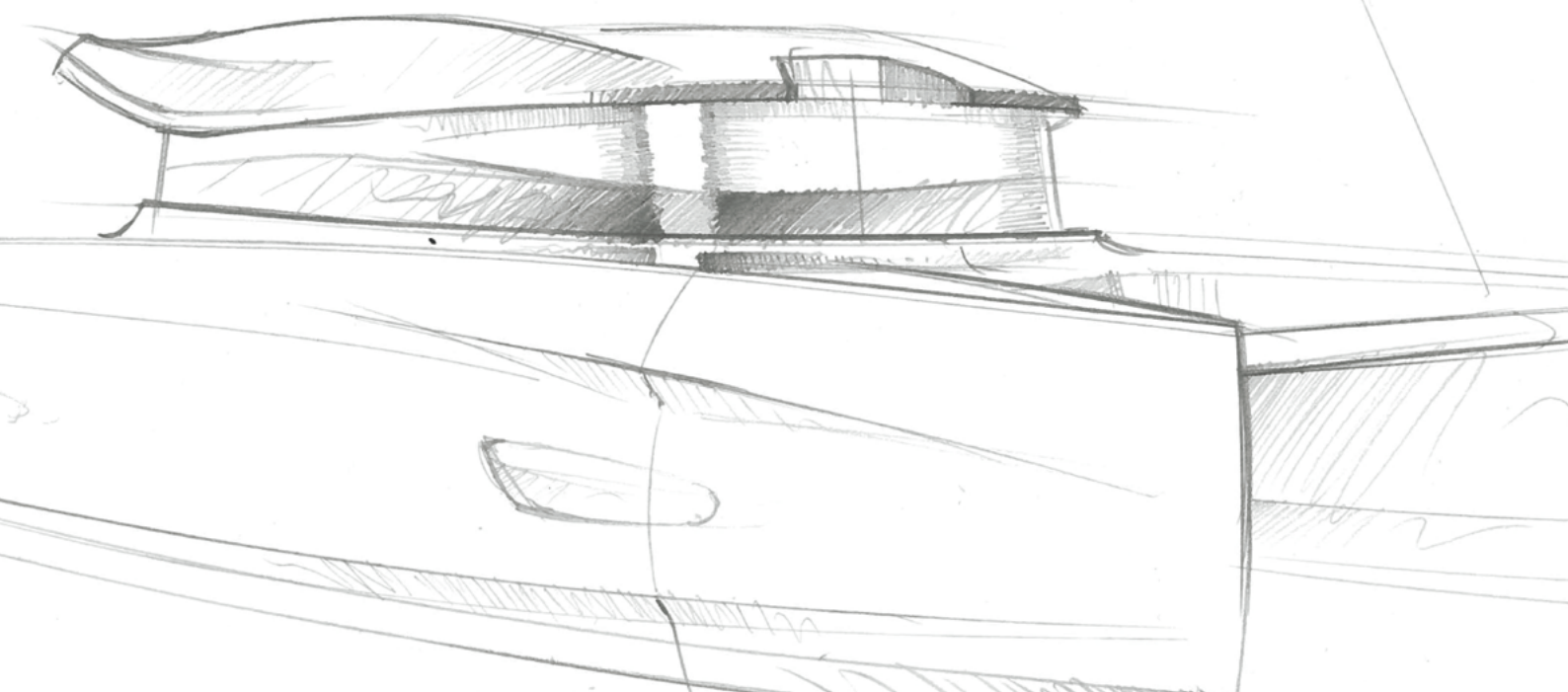



MY EXCESS

Join us on My Excess, an online rubric specifically designed for Excess catamaran owners and enthusiasts. As a member of My Excess, you will access exclusive information, receive invitations to special preview events and benefit from our partners' exclusive offers.

My Excess is not only a online platform; it is a dynamic community that celebrates a passion for sailing and adventure. Step on board and explore a universe where each detail has been designed to enhance your experience as a member of the Excess tribe.

Welcome to My Excess!

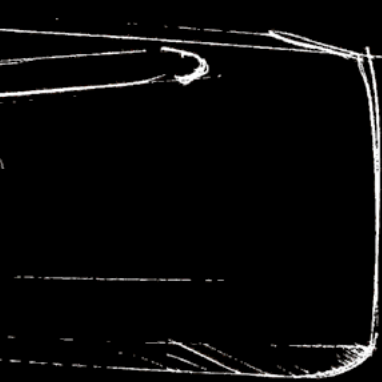
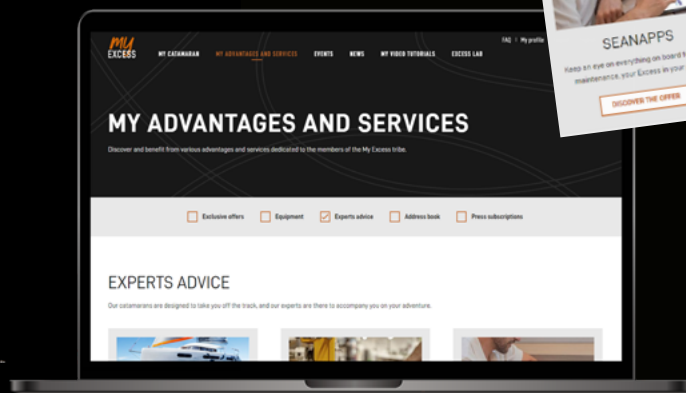
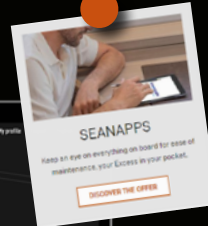
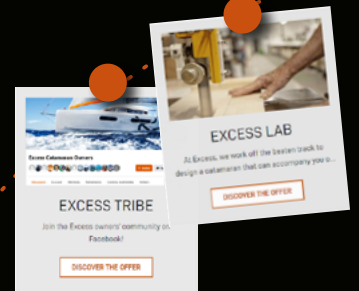

LESS IS MORE

In accordance with our DNA, at Excess we believe that the best way to be on the water, for us and our planet, is under sail! That's exactly why we want to design cruising catamarans with larger sail plans and reduced weight, capable of sailing under all conditions.

We look for simple and smart solutions in order to offer the necessary comfort and functions on board, while reducing our environmental impact.

LESS

**MATERIALS
CONSUMPTION
ENERGY
WASTE
TRANSFORMATION
RESSOURCE COLLECTION**

MORE

**SUSTAINABILITY
RELIABILITY
SOBRIETY**

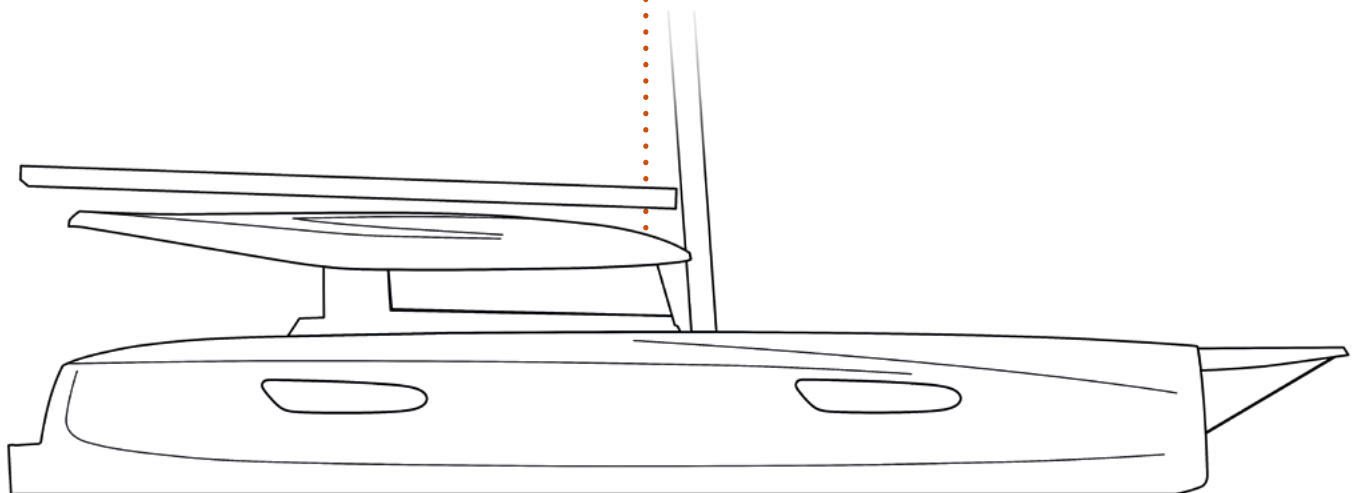

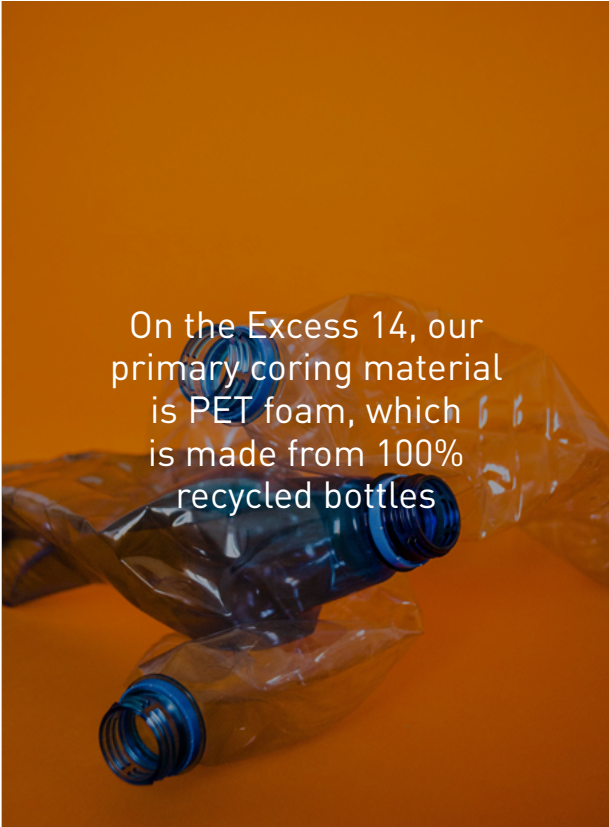
A photograph of several clear plastic PET bottles with blue caps, lying on a solid orange background. The bottles are slightly crumpled and scattered.

On the Excess 14, our primary coring material is PET foam, which is made from 100% recycled bottles

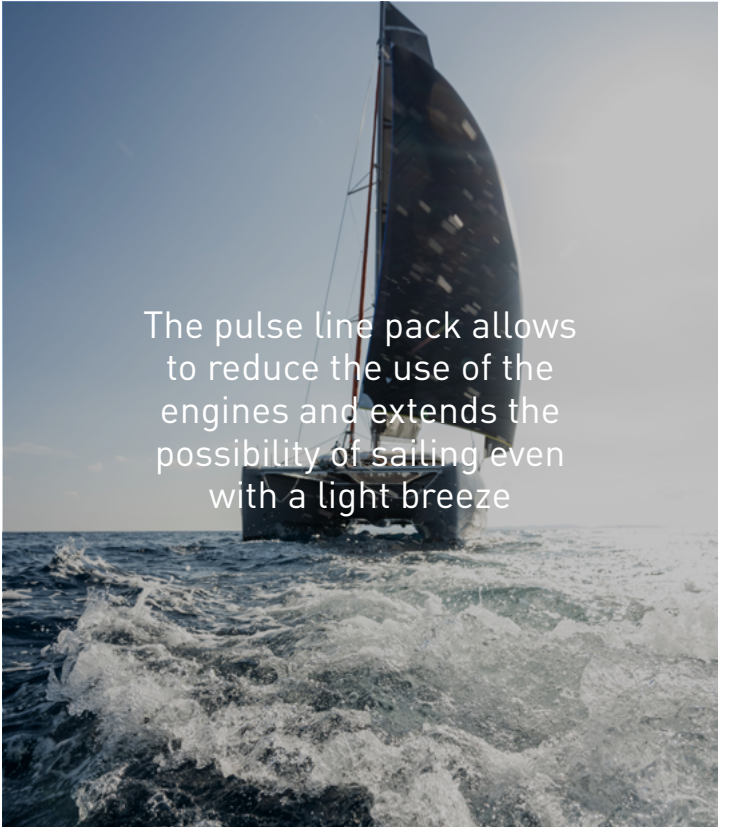
A photograph of a sailboat with a dark sail, sailing on a choppy sea under a clear sky. The boat is viewed from a distance, moving away from the viewer.

The pulse line pack allows to reduce the use of the engines and extends the possibility of sailing even with a light breeze

A photograph showing a close-up of a white electric propulsion system installed on a boat's deck. An orange steering wheel is visible in the foreground.

In 2021, we launched our first Excess prototype with an electric propulsion: the Excess 15 «E'Lab»

A close-up, blurred photograph of natural fibers, likely hemp, showing their texture and color. The fibers are arranged in a somewhat circular pattern.

We are progressively introducing natural fibers, such as hemp, in the built process of our boats. In 2023, Groupe Beneteau mould over 30.000 GRP parts using bio-sourced resins with natural core materials

A photograph of a dense forest of tall, thin trees, viewed from a low angle looking up towards the sky. The trees are green and their trunks are dark.

In 2023, 38% of the resin used to build our catamarans are bio sourced.



EXCESS IN YOUR EARS !

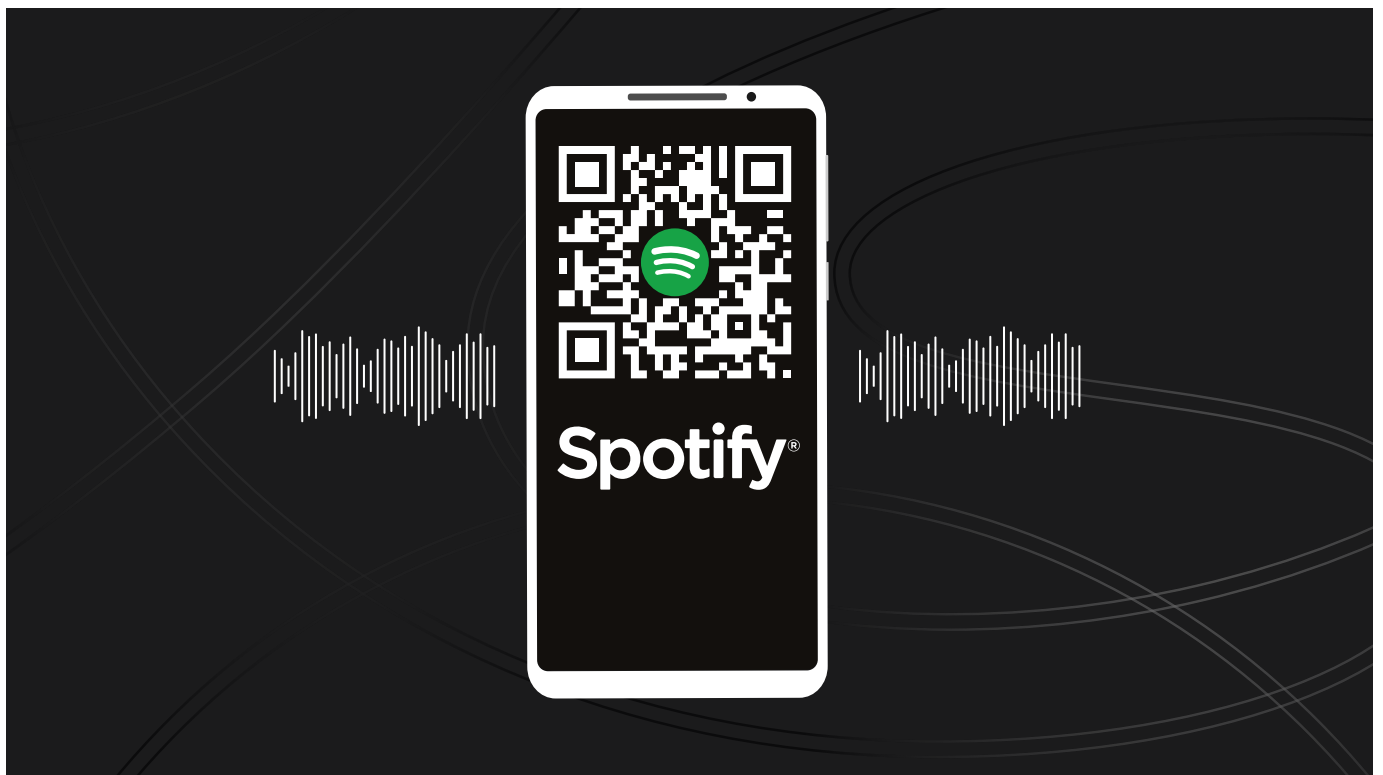

FOLLOW US !





XCS
Excess